

HL air admittance valves take care of pressure equalizations



Suitable for the installation in drywalls with a depth of only 75 mm



HL HUTTERER & LECHNER GMBH
EASY & SAFE

EASY & SAFE



Cross-trade complete solution: Installation by the plumber, completion by the tiler. No additional, expensive installation box necessary. ✓



Preventive ventilation of bathroom drain pipes prevent water from being sucked out of the siphon or gurgling in bathroom tubs. ✓



Easy cleaning/revision: The newly designed complete cartridge can easily be removed and reattached with the bayonet lock. ✓



Components like covers and complete cartridges can easily be removed, cleaned or changed without levering, years after installation. ✓



More installation friendly: The fastening straps allow the valve to be fastened to horizontal profiles of drywalls. ✓



Free access to the pipe system with a spiral spring after removing the cover and complete cartridges. ✓



HL905N Flat concealed air admittance valve

HL905N Flat concealed air admittance valve complet with white cover

Data

Material	PP/ABS
Connection	DN50/75
Airflow capacity	13 l/s
Standard	EN 12380-A1, EN 12056-2



Recommended for In-wall installation, ventilation of secondary downpipes and single- or multiple downpipes, which are more than 4m away from the downpipe (EN12056-2)
Due to the flat design an installation in plasterboard walls with 75mm inner dimension is possible

Additional information By installing this air admittance valve, you make sure, that enough air is getting into the outlet pipes of the whole bathroom, so the water inside the trap is not sucked out by vacuum, which might cause bad odour. The functional cartridge is removable for cleaning and revision and, additionally, allows an open access to the sewer system. Please see installation video at www.hl.at

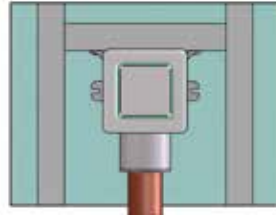
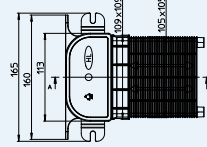
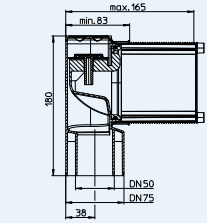
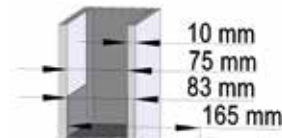

HL905.1, (.2), (.3), (.4) Cover plate for HL905N HL905.1V, (.2V) Screwwable cover for HL905N

Daten

Material	ABS
Dimension	125 x 125 mm
Recommended for	HL905N

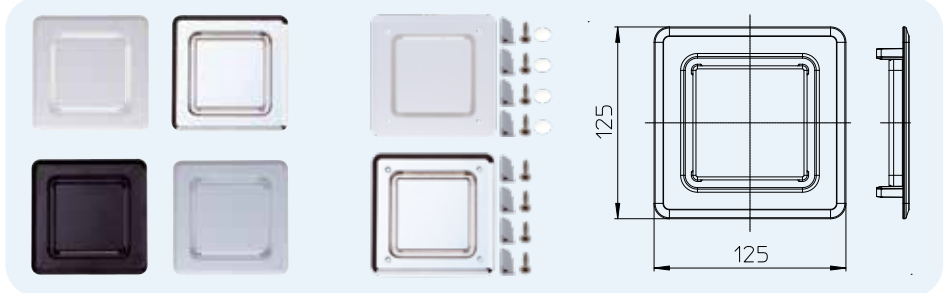

HL Hutterer & Lechner GmbH
 Brauhausgasse 3-5, A-2325 Himberg, Austria
 T: +43 / (0)2235 / 862 91-0
 F: +43 / (0)2235 / 862 91-31
 office@hl.at
 www.hl.at